

# ELEVATION TEN

2012-2013 Facility Rental Brochure



AN EVENT SPACE AS *unique* AS THE WINE

THE PERFECT

## location

Elevation Ten Winery is located in the Old Sugar Mill, in the quaint river town of Clarksburg. Just 15 minutes south of Downtown Sacramento, this unique tasting room offers a great location for your next fundraiser, company party or special event!

Our large open floor plan includes a spacious tasting room, complete with a flat screen television, two wine bars and a beautiful dining table with seating for ten. Our cozy wine club lounge also boasts a second flat screen television and comfortable lounge seating. Our back storage area can easily be converted into event seating, and can open out to our beautiful back patio to extend your event outdoors.

Our 55" flat screen TVs are perfect for slideshows, presentations or event graphics. Our tasting room staff can help you facilitate all of your audio/visual needs.

During your event, you will be able to offer your guests our selection of artisanal wines created by our wine maker Marco Cappelli. Our current wine selection includes two white wines, six red wines, and four dessert wines. Your event package can include wine tasting for each guest, or you can purchase a wine package to be served by the glass. Each wine is hand-crafted, and is a great companion to catered meals, fruits, cheeses or desserts.



## FACILITY RENTAL RATES

*include*

- Full use of our tasting room including main tasting room, Wine Club lounge and back room
- Use of our back patio, including tables and chairs, patio lights and portable space heaters
- 2 - 55" flat screen TVs which can be used for presentations, slide shows or event graphics
- Wine glasses for event
- Assistance with set up and event clean up
- Event coordination (coordination of catering, rentals, etc.)
- Staffing for event (depending on size of your group)
- Use of dining table (seats 10), lounge chairs and barstools
- Kitchen with full-size refrigerator, microwave and coffee maker



## TAKE THE *party* OUTSIDE

Our beautifully rustic back patio area offers a great way to extend your event outdoors. Complete with tables, chairs, outside wine bar and water fountain, your guests are sure to enjoy an evening party under the lights! The steel beam framework above this space allows for ample decorating opportunities.

### Our back patio offers the following amenities:

- Rustic wine bottle water fountain
- Outdoor wine bar
- Tables and chairs
- Redwood benches
- Overhead bulb lights strung across entire length of the patio
- Use of portable space heaters
- Double doors that open from the tasting room to the back patio

### Our event venue is the perfect place for:

- Engagement Dinners/Parties
- Baby Showers
- Wedding Showers
- Company/Management Meetings
- Staff Luncheons
- Fundraising Events
- Corporate Retreats
- Holiday Parties
- Birthday/Anniversary Parties
- Release Parties

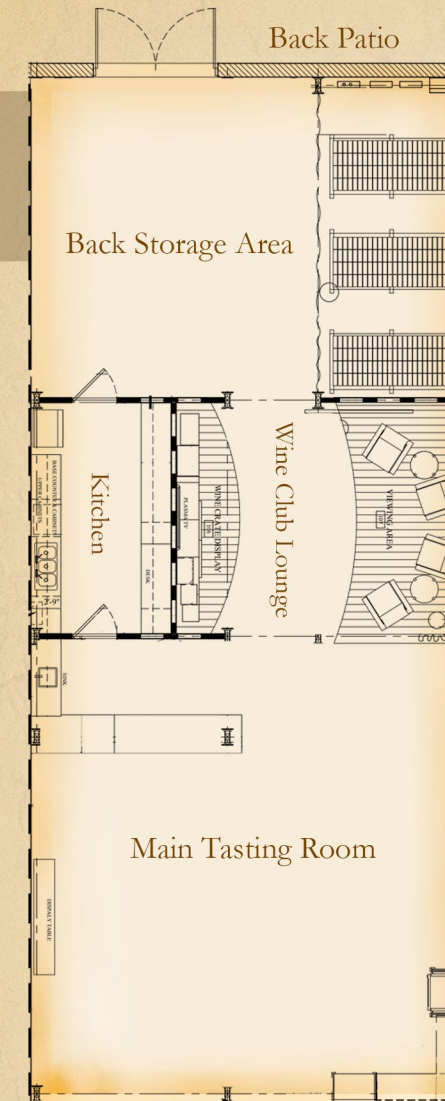
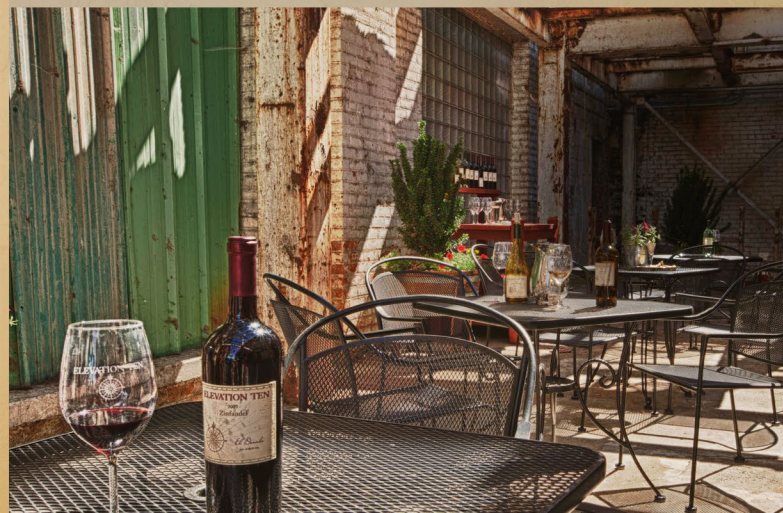

## SPACE DETAILS

Tasting Room:  
1,500 sq. ft.

Outside Patio:  
1,152 sq. ft.

Maximum Occupancy  
(mixer style): 90

Maximum Occupancy  
(seated 8 people per table): 60

### CATERING AND RENTALS:

We are happy to let you bring in your favorite vendors and recommend that you select local vendors for catering, linens, china, flatware, glassware and all other event rental needs. Our team will be

able to provide you with a list of vendors in our area if needed.

### EVENT DATES:

Events can be scheduled at any time Monday through Thursday; however, we will need to confirm facility availability on Fridays, Saturdays and Sundays. Private events can be scheduled in our tasting room during business hours; please call for more information.

## CREATE A *custom* EVENT

### PRICING STRUCTURE

| Up to 20 Guests: | 2 hours | 3 hours | 4 hours |
|------------------|---------|---------|---------|
| Room Rental Fee  | \$200   | \$260   | \$330   |

A minimum purchase of one case of wine is required. (can be used at event)

Fee includes: One manager and two staff members, coordination of catering and rentals.

| Up to 30 Guests: | 2 hours | 3 hours | 4 hours |
|------------------|---------|---------|---------|
| Room Rental Fee  | \$280   | \$380   | \$480   |

A minimum purchase of one case of wine is required. (can be used at event)

Fee includes: One manager and three staff members, coordination of catering and rentals.

| Up to 40 Guests: | 2 hours | 3 hours | 4 hours |
|------------------|---------|---------|---------|
| Room Rental Fee  | \$400   | \$525   | \$660   |

A minimum purchase of 1 1/2 cases of wine is required. (can be used at event)

Fee includes: One manager and four staff members, coordination of catering and rentals.

**BOOKING LARGE GROUPS:** Please contact our tasting room manager for pricing and details on events with over 40 guests.

**DEPOSIT:** A \$100 deposit is required two weeks in advance of event date.

**WINE CLUB MEMBERS:** Wine Club Members receive first priority for scheduling events and 15%-20% off wine purchases during events.

\*Pricing is subject to change and does not include: catering, entertainment, decoration, tables/chairs, linens, dinnerware and flatware.

# LET US HELP YOU PLAN YOUR NEXT *event*

We look forward to helping you plan your next event in our tasting room. Please call us for more information on putting together the perfect event package. For more information contact our Tasting Room Manager, Jenny Loges by phone at (916)744-1710, or by email at [jloges@elevationten.com](mailto:jloges@elevationten.com).

## **Directions**

The Old Sugar Mill is located in the historic town of Clarksburg, fifteen minutes southwest of the Capitol building in Sacramento.

## **From Sacramento:**

Take I-5 south, Exit Pocket/Meadowview Road then go LEFT on Pocket Road. Turn RIGHT on Freeport Blvd. Go through the little town of Freeport and make a RIGHT to cross the Freeport Bridge. Make a LEFT on South River Road - 3.1 miles, turn RIGHT on Willow Point Road, then LEFT on Willow Avenue.

## **From the Bay Area:**

Take I-80 East to Sacramento. Once you cross the Yolo Causeway, follow signs for Hwy 50 to Tahoe in order to catch I-5 south. Exit Pocket/Meadowview Road turn LEFT on Pocket Road then RIGHT on Freeport Blvd. Go through the little town of Freeport and make a RIGHT to cross the Freeport Bridge. Turn LEFT on South River Road. - 3.1 miles, turn RIGHT on Willow Point Road then Left on Willow Avenue.

